

NOTES:
 1) ALL DOORS 3'-0" UNLESS OTHERWISE NOTED.
 2) DIMENSIONS ARE FOR INTERIOR REFERENCE ONLY, AND DO NOT REFLECT TOTAL SUITE SQUARE FOOTAGE.

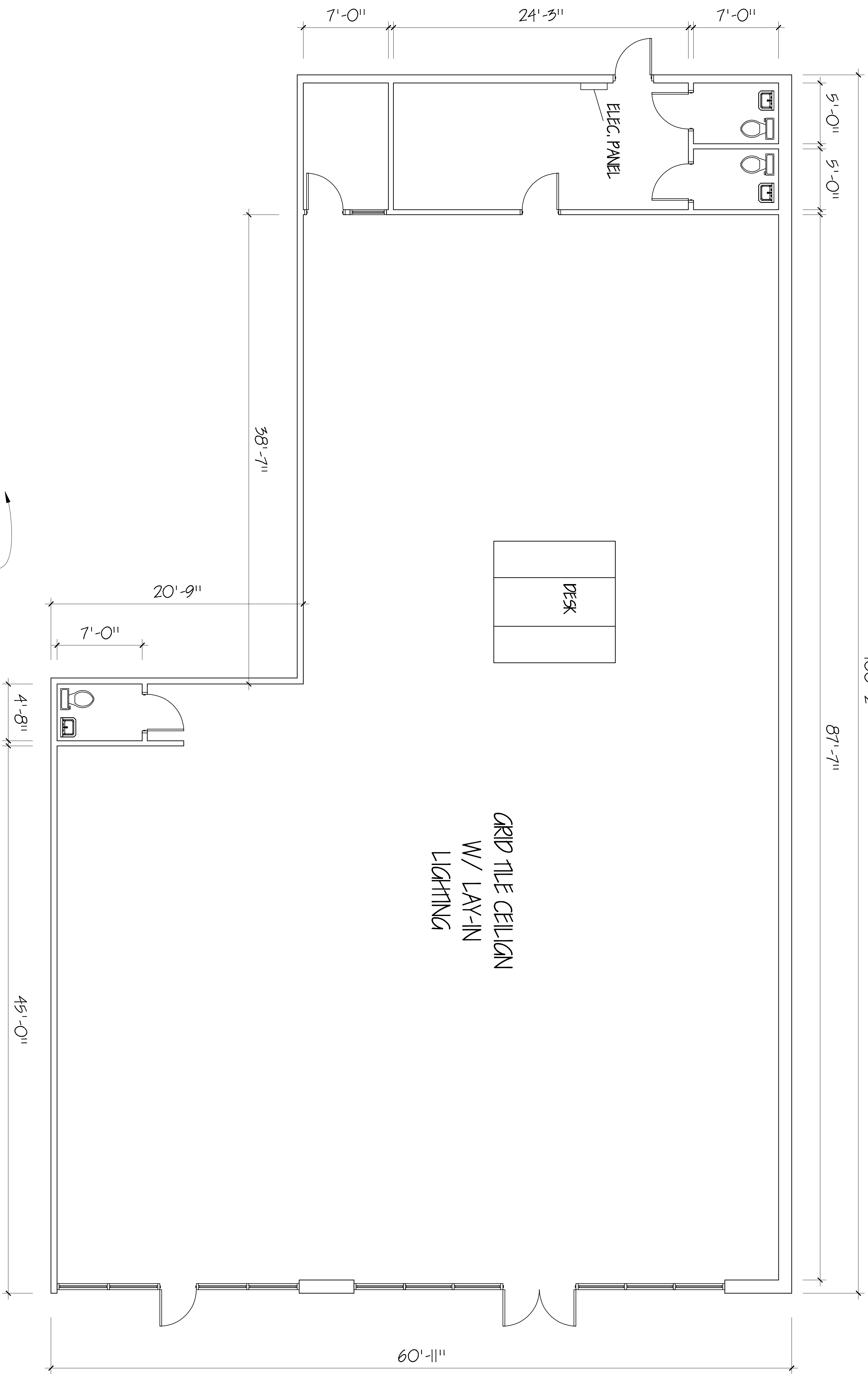

1" = 1' SHEET A-1 SHEETS 1	DRAWN M.W. ALLEN
	DATE 6/1/2009
	JOB NO. MIMMS DESIGN

SPACE PLAN

SCALE
AS SHOWN

**KINGS MARKET
 SUITE 340
 ROSWELL, GA**

**MALON D MIMMS CO.
 85-A MILL ST.
 ROSWELL, GA 30075
 770-518-1100**

